

IPS Flange Adapters

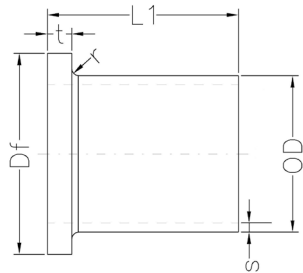

- Molded from black PE 100/ 4710 resin & NSF-61 certified
- Complies with the following product standards: ASTM D2513, D3261, D3350, and AWWA C906

SDR 9 (STANDARD DIMENSION RATIO) 250 PSI (WORKING PRESSURE AS 73.4° F)

Product Code	Nominal Diameter (inch)	L1 (inch)	s (inch) Wall	OD (inch)	Df (inch)	t (inch) Wall	r (inch)	Weight (lbs.)
RF-FLNG-R9-02.00	2" IPS	7.4	0.26	2.38	3.85	0.49	0.19	0.59
RF-FLNG-R9-03.00	3" IPS	6.03	0.39	3.50	5.00	0.84	0.28	1.16
RF-FLNG-R9-04.00	4" IPS	6.33	0.50	4.50	6.54	1.00	0.28	2.20
RF-FLNG-R9-06.00	6" IPS	7.247	0.74	6.63	8.60	1.00	0.28	4.67
RF-FLNG-R9-08.00	8" IPS	8.105	0.96	8.625	10.70	1.12	0.35	10.93
RF-FLNG-R9-10.00	10" IPS	11.98	1.19	10.75	12.75	1.54	0.35	17.29
RF-51.112.0012.09*	12" IPS	12.34	1.42	12.75	15.50	1.83	0.35	27.84

SDR 7 (STANDARD DIMENSION RATIO) 335 PSI (WORKING PRESSURE AS 73.4° F)

Product Code	Nominal Diameter (inch)	L1 (inch)	s (inch) Wall	OD (inch)	Df (inch)	t (inch) Wall	r (inch)	Weight (lbs.)
RF-51.112.0002.07*	2" IPS	7.4	0.34	2.38	3.85	0.49	0.19	0.77
RF-FLNG-R7-03.00	3" IPS	6.03	0.50	3.50	5.00	0.84	0.28	1.39
RF-FLNG-R7-04.00	4" IPS	6.33	0.64	4.50	6.54	1.00	0.28	2.41
RF-FLNG-R7-06.00	6" IPS	7.247	0.95	6.63	8.60	1.00	0.28	5.82
RF-FLNG-R7-08.00	8" IPS	8.105	1.23	8.625	10.70	1.12	0.35	11.79
RF-FLNG-R7-10.00	10" IPS	11.98	1.54	10.75	12.75	1.54	0.35	17.54
RF-51.112.0012.07*	12" IPS	12.34	1.82	12.75	15.50	1.83	0.35	30.35

*Produced at AGRU Austria.

Notes:

- All dimensions shown are nominal and subject to manufacturing tolerance OD and minimum wall are determined in accordance with ASTM standards. Drawing shown is an approximation only.
- Please refer to DOT pressure requirements for natural gas applications.
- Fittings are marked to meet standards to which the product is produced and labeled.

