

## IPS Flange Adapters

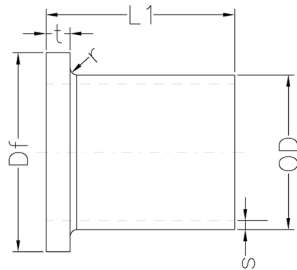

- Molded from black PE 100/ 4710 resin & NSF-61 certified
- Complies with the following product standards: ASTM D2513, D3261, D3350, and AWWA C906

### SDR 17 (STANDARD DIMENSION RATIO) 125 PSI (WORKING PRESSURE AT 73.4° F)

Product Code	Nominal Diameter (inch)	L1 (inch)	s (inch) Wall	OD (inch)	Df (inch)	t (inch) Wall	r (inch)	Weight (lbs.)
FF-51.112.0002.17	2" IPS	6.10	0.14	2.38	3.94	0.55	0.20	0.37
FF-51.112.0003.17	3" IPS	6.10	0.21	3.50	5.00	0.67	0.28	0.77
FF-51.112.0004.17	4" IPS	6.10	0.26	4.50	6.61	0.79	0.28	1.26
FF-51.112.0006.17	6" IPS	8.50	0.39	6.63	8.50	1.02	0.28	3.22
FF-51.112.0008.17	8" IPS	10.51	0.51	8.63	10.63	1.02	0.35	6.44
FF-51.112.0010.17	10" IPS	11.61	0.63	10.75	12.99	1.18	0.35	10.63
FF-51.112.0012.17	12" IPS	10.83	0.75	12.75	15.75	1.38	0.35	14.81
RF-51.112.0014.17*	14" IPS	13.0	0.83	13.94	17.5	1.50	0.43	22.10
RF-51.112.0016.17*	16" IPS	13.0	0.94	15.93	20.0	1.77	0.43	31.0
RF-51.112.0018.17*	18" IPS	13.0	1.06	17.92	21.38	1.89	0.43	35.8

### SDR 11 (STANDARD DIMENSION RATIO) 200 PSI (WORKING PRESSURE AT 73.4° F)

Product Code	Nominal Diameter (inch)	L1 (inch)	s (inch) Wall	OD (inch)	Df (inch)	t (inch) Wall	r (inch)	Weight (lbs.)
FF-51.112.0075.11	¾" IPS	4.02	0.09	1.05	1.85	0.39	0.12	0.07
FF-51.112.0001.11	1" IPS	4.02	0.12	1.32	2.36	0.39	0.12	0.11
FF-51.112.0125.11	1¼" IPS	4.02	0.15	1.66	2.80	0.39	0.20	0.15
FF-51.112.0150.11	1½" IPS	4.02	0.17	1.90	3.15	0.39	0.20	0.22
FF-51.112.0002.11	2" IPS	6.10	0.22	2.38	3.94	0.55	0.20	0.49
FF-51.112.0003.11	3" IPS	6.10	0.32	3.50	5.00	0.67	0.28	0.95
FF-51.112.0004.11	4" IPS	6.10	0.41	4.50	6.61	0.79	0.28	1.73
FF-51.112.0006.11	6" IPS	7.87	0.60	6.63	8.50	1.02	0.28	4.08
FF-51.112.0008.11	8" IPS	10.63	0.79	8.63	10.83	1.26	0.35	9.08
FF-51.112.0010.11	10" IPS	12.99	0.98	10.75	12.99	1.38	0.35	14.29
FF-51.112.0012.11	12" IPS	15.75	1.16	12.75	15.75	1.50	0.35	20.15
RF-51.112.0014.11*	14" IPS	13.0	1.27	13.94	17.5	1.50	0.43	29.8
RF-51.112.0016.11*	16" IPS	13.0	1.45	15.93	20.0	1.77	0.43	40.2
RF-51.112.0018.11*	18" IPS	13.0	1.64	17.92	21.38	1.89	0.43	46.5

\*Produced at AGRU Austria.

Notes:

- All dimensions shown are nominal and subject to manufacturing tolerance OD and minimum wall are determined in accordance with ASTM standards. Drawing shown is an approximation only.
- Please refer to DOT pressure requirements for natural gas applications.
- Fittings are marked to meet standards to which the product is produced and labeled.